

Accordion Door



- An easy to install fabric partition system with only a top track.
- Partition is made by robust anti bacterial, fire retardant fabrics with a variety of design options.
- Minimal stacking space enables maximum space utilisation.
- The door is held in place by magnets. Locking option is available.
- Ideal as a partition in living rooms, walk in wardrobes and several other areas.

ACCORDION DOOR

Accordion Door Features.

■ A variety rich fabric.

From Natural to modern to see through, a wide line up. not only design but also functional aspects. items resistant to bacteria and dirt are available.

Fabric Taste

- Modern** – We adopted innovative design from cool modern patterns such as leather style, fabric style to retro-modern geometric patterns.
- See Through** – Fabrics featuring a bright and open feeling such as semi-transparent fabric with transparent stripes and completely transparent fabric are available.
- Natural Basic** – Texture like nature texture of wood grain is reproduced.
- Simple Face** – It is plain fabric that is easy to coordinate with the wallpaper of the ceiling and walls and the material of the floor.
- Feeling** – Basic fabric motif with an abstract pattern close to solid colour.

Fabric Function

Antibacterial	Matrix (-P 16)	Sharp (-P 18)
18 Series	Legal (-P 20)	New Tracy (-P 22)
42 Patterns	Wave (-P 24)	Smoke (-P 26)
	Stream (-P 28)	Chic (-P 32)
	Liberty (-P 34)	J-Tone (-P 36)
	Clay (-P 38)	Ash (-P 40)
	Airo (-P 42)	Nova (-P 44)
	Olive (-P 46)	Reguard (-P 64)
	Sehua (-P 66)	

By applying antibacterial treatment, you can suppress the growth of bacteria, you can always use it cleanly. Recommended for toilets and washrooms, hospitals and elderly facilities.

- Closer Excel grip, closer light grip, long grip, handle lock
- Antibacterial processing is also applied to the specification grip.
- Antibacterial effect test data (according to JIS-Z-2801) TD-5006

	Number of violated bacteria immediately after inoculation	Number of violocutes after 24 hours
Staphylococcus aureus	260,000	Less than 10
E	340,000	180

- The table above is a test measurement. It is not a guaranteed value.
- The above data is the numerical value according to the test in TD-5006. There is error due to leather No.

Darkness Sable Series (-P 58)
Unlike conventional leather, from the dark side when used as a partition Even if you look at the bright side, see through the frame and wires of the product body you can't.

1 Series

2 Patterns

Please be careful. Even if you use light-shielding leather, it is not possible to completely shield the light shielding due to the structure, so photographs It is not suitable for darkrooms that develop or bake.

Olefin Sehua Series (-P 66)
We use materials such as polyethylene and polypropylene that do not generate toxic gases. It is an eco-friendly leather.

1 Series

2 Patterns

Handle: Antibacterial processing done. There is also a "long handle" which is large and easy to grasp.

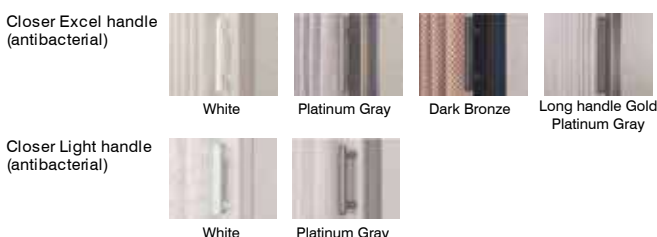

Antifouling By coating the antifouling agent, it is hard to stain, making it easy to clean even if it gets dirty.

27 Series
63 Patterns

- Wipe off any dirt you care about.



Doodle and food stains are clean with a neutral detergent diluted with water.

- Super antifouling and antifouling processing performance data.(according to our experimental results)

Sr	Stained object	Process	Super Antifouling	Antifouling	Regular Fabric
1.	Soy sauce		5th grade	5th grade	3rd grade
2.	Coffee		5th grade	4th grade	3rd grade
3.	Crayon		5th grade	4th grade	3rd grade
4.	Water-based magic (Black)		5th grade	4th grade	3rd grade
5.	Oily Magic (Black)		Grades 4-5	3rd grade	1st grade
6.	Oily Magic (Red)		Grades 4-5	3rd grade	1st grade

For 1 to 4 contaminants, leave for 24 hours, wipe with a neutral detergent and measure the remaining condition of dirt on grayscale, Leave for 5 and 6 contaminants for 24 hours, (ethanol) and the remaining condition of dirt is measured in gray scale.

- How to display test results

Grade	The rest of the dirt
1st Grade	The dirt remains thick.
2nd Grade	They are quite dirty.
3rd Grade	A little dirt remains.
4th Grade	There is little dirt left.
5th Grade	There is no dirt left.

(According to JIS-L-0805)

Super - Antifouling Reguard series (-P 64)
By laminating a thin film on the surface of the fabric, the antifouling property was further enhanced. Ideal for particularly dirty places.

1 Series

2 Patterns

Antistatic Plant Series (-P 30)
By subjecting the fabric surface to static electricity hardening process, it prevents sticking of fabric and fabric which occurs when fabric is folded.

1 Series

1 Patterns

- Antistatic performance data (according to JIS-K-6911) TD-5015

Surface resistance (Ω)	1.9×10^{12}
Volume resistance (Ωcm)	5.8×10^{12}



- The above table shows measured values by test. It is not a guaranteed value.
- The above data is based on the test at TD-5015.

Upper see-through specification (-P77)

Top is a see-through fabric, lower part is opaque fabric. Even when the door is closed, there is little sense of blockage, and natural light is allowed to enter.

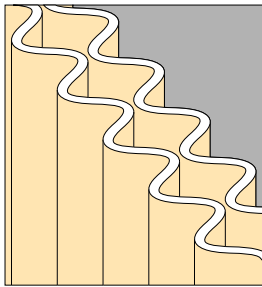
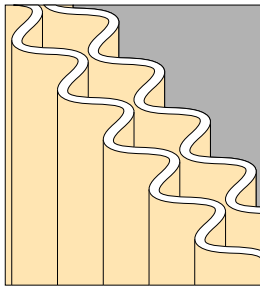

Product Line-up.

Product Name	<p>CLOZA EXCEL High-grade type Widely allowable to use.</p>	<p>CLOZA LIGHT Standard type Operability is light and smooth.</p>
		
Structure	<p>Duplex</p>  <p>The double structure that is inside is a framework with fabric posted on it.</p>	<p>Duplex</p>  <p>The double structure that is inside is a framework with fabric posted on it.</p>
Allowable Size	<p>Product width : 550-5,000 mm Product height : 610-3,200 mm</p>	<p>Product width : 600-3,000 mm Product height : 1,610-2,400 mm</p>
Allowable Colours	66 colours	61 colours
Track and Handle Colour	<p>White Platinum Gray Dark Bronze</p>	<p>White Platinum Gray</p>
Optional Specs	<p>Long handle type Both sides handle type Front & back different fabric type Upper part see-through type Inlay system type Lock system type Handle lock system type Curved type Cut-out</p>	<p>Both side handle type Front and back different fabric type Inlay system type Curved type *For customized products only.</p>

ACCORDION DOOR

Specifications and Structure.

CLOZA EXCEL

Product Overview

• Structure Drawing

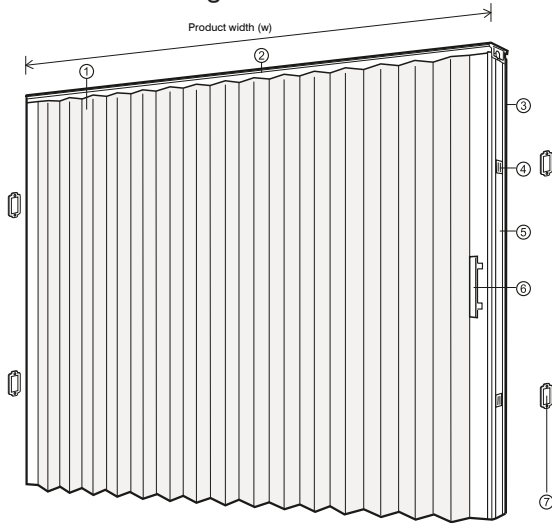

Components	Materials
Fabric	PVC
Track	aluminum extrusion
Frame Cover	aluminum extrusion
Magnet	stainless steel press forming, plastic molded, ferrite magnet
Frame Cushion	Plastic molded extrusion
Handle (antibacterial)	aluminum alloy
Magnet Adsorption plate	stainless steel press forming

• Attachments

Magnet Adsorption Plate

Product height (H)	Number of Plate
-2,200 mm	4
-2,210 mm	6

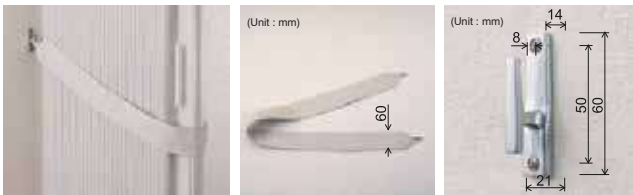

Tieback (using the same Fabric) Tieback Hook / Type F (Silver)

Magnet Adsorption Plate

Attached to the product width is 4510 mm or more, or the product of curved type.

	Owo-way Draw	Split Draw
Tieback (using the same Fabric)	1	2
Tieback Hook Type F	2	4

• Available Colour Table for Standard Parts

Parts colour can be selected from the following three colours. If not specified, we apply a recommended fabric colour.

	White	Platinum Gray	Dark Bronze
Track			
Handle			
Magnet Adsorption Plate			

• Side View

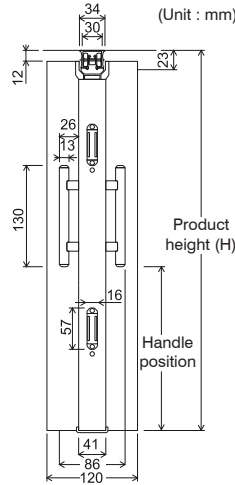

• Handle Position

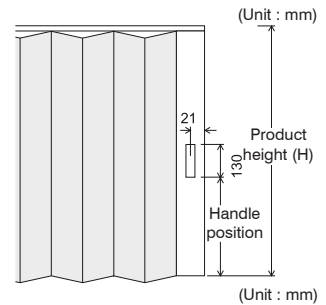

Product height (H)	Handle Position
610-900	H-315
910-1,200	H-515
1,210-1,700	H-595
1,710-1,800	H-695
1,810-1,900	H-795
1,910-2,000	H-895
2,010-2,100	H-995
2,110-2,300	H-1,095
2,310-2,400	H-1,195
2,410-2,500	H-1,295
2,510-2,600	H-1,395
2,610-2,700	H-1,495
2,710-2,800	H-1,595
2,810-2,900	H-1,695
2,910-3,000	H-1,795
3,010-3,100	H-1,895
3,110-3,200	H-1,995

• Track Cross Section

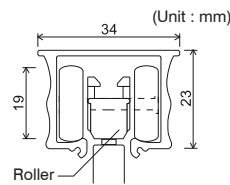

• Number of the Track

Product Width (W)	Number of the Track
550-1,200 mm	1
1,210-1,650 mm	1
1,660-2,400 mm	1
2,410-3,300 mm	1
3,310-4,000 mm	1
4,010-4,500 mm	1*Option 2* Standard
4,510-4,800 mm	2
4,810-5,000 mm	2

*If the product width is between 4,010 - 4,500 mm, jointing two tracks is the standard specification. One track type is allowable by optional, please inquire the transportation method and specify the size.

Allowable Size

Product Width (W)	550-5,000
Product height (H)	610-3,200

*For ordering, round down the nearest 10mm both in width and in height.
*Maximum allowable size: One-way draw is of 5 m; Split draw is of 10 m.

Stack-up Guide

Product Width (W)	Stacked-up Height	Product Width (W)	Stacked-up Height
900	215	3,300	575
1,200	265	3,600	620
1,500	305	4,000	695
1,800	355	4,200	720
2,100	405	4,500	770
2,400	430	4,800	820
2,700	480	5,000	870
3,000	550		

Product Weight Guide

Product Width 1,000 mm X Product height 2000 mm	: 10 Kg.
Product Width 1,500 mm X Product height 2000 mm	: 14 Kg.
Product Width 2,000 mm X Product height 2000 mm	: 16 Kg.

Installation Method

1. Installing of the main unit



Caution

Installing and removing should be done always by two people.
Fabric that tied the door body should not remove until the installing is end.

- ① Remove the track side cover, pass through rollers of the body to the track, set the track on the body, and disconnect the alignment rod slowly with pliers.

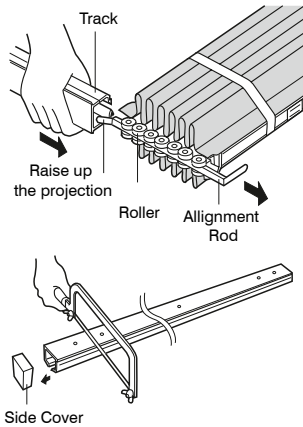

(For cutting the Track)

Remove the track side cover, and cut the track of opposite side of the roller stop screw hole with hacksaw. Clean up metal chips remaining in the track.

- ② Lift up the body, and attach the track with screws (pan ϕ 3.5 X 25). (One person hold the body, and the other person attach the track.) Install the track with screws in order: first in the center of the track, and next both ends.
*Be careful not to scrape the track with a screwdriver so as not to become worse the slipping of rollers.

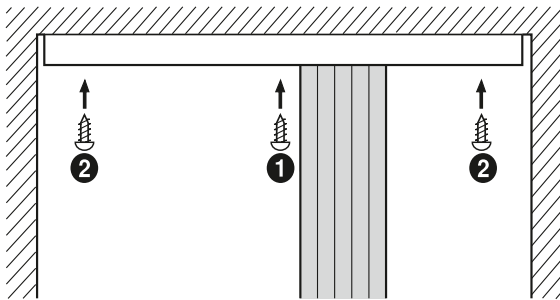

(For connecting Track)

- First, attach one track to the body.
 - Attach the splice pin to the other track and joint them not to make any gap in the seam of both tracks.
 - Slide the Splice pin in the seam of tracks by using a fine-tipped tool such as a flat-blade screwdriver.
- *In the case of split draw, attach the intermediate stop in the connect part.

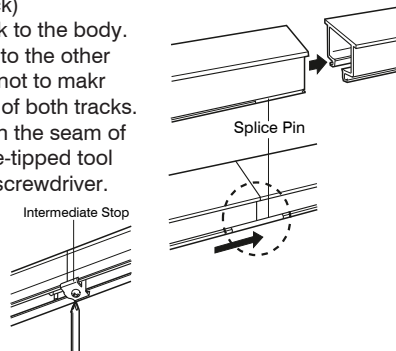

- ③ Attach the Magnet Adsorption Plate with screw (countersunk ϕ 3.1 X 16) to fit the Magnet position of the body.

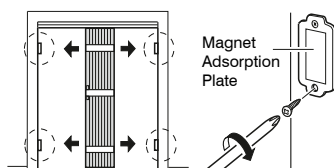

- ④ Remove the Fabric that tied the body.

2. Removing of the main unit



Caution

Because it is dangerous to drop and fall down the main body, another person should always sustain the main body by hand.

- ① Fold up the body, and move to the center.
② Previously remove the screws at both ends, and remove the screw of the center last.

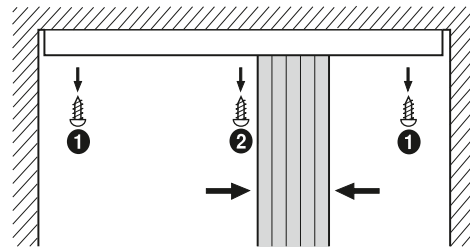

Operation Method

Opening and closing should always be done by gripping the handle.

How to Take Measurements

*For the product dimensions, specify to round down the nearest 10mm.

Width: Internal dimensions of a door frame.

Height: subtract approx 20mm from the height of the opening height.

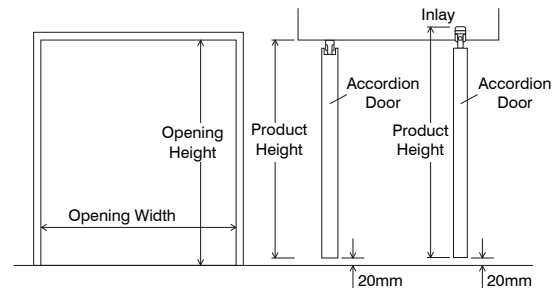

*Product height: from the track top to the bottom of the product body.

Subtract approx. 20mm from the top of the carpet if you lay the carpet.

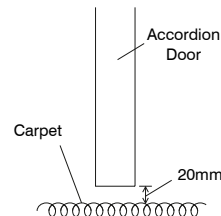

ACCORDION DOOR

Specifications and Structure.

CLOZA LIGHT

Product Overview

• Structure Drawing

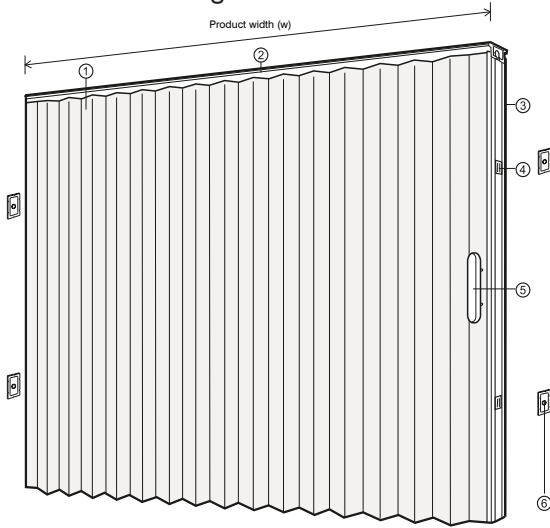

Components	Materials
① Fabric	PVC
② Track	aluminum extrusion
③ Frame Cover	aluminum extrusion
④ Magnet	stainless steel press forming, plastic molded, ferrite magnet
⑤ Handle (antibacterial)	Plastic molded
⑥ Magnet Adsorption plate	stainless steel press forming

• Attachments

Magnet Adsorption Plate

Product height (H)	Number of Plate
-2,200 mm	4
-2,210 mm	6

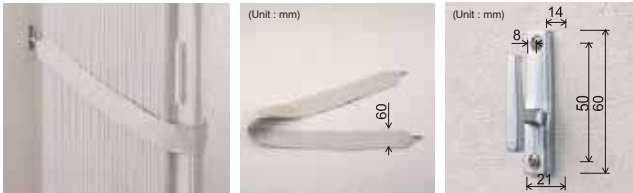

Tieback (using the same Fabric) Tieback Hook / Type F (Silver)

Magnet Adsorption Plate

Attached to the product width is the product of curved type.

	Owo-way Draw	Split Draw
Tieback (using the same Fabric)	1	2
Tieback Hook Type F	2	4

• Available Colour Table for Standard Parts

Parts colour can be selected from the following two colours. If not specified, we apply a recommended fabric colour.

	White	Platinum Gray
Track		
Handle		
Magnet Adsorption Plate		

• Side View

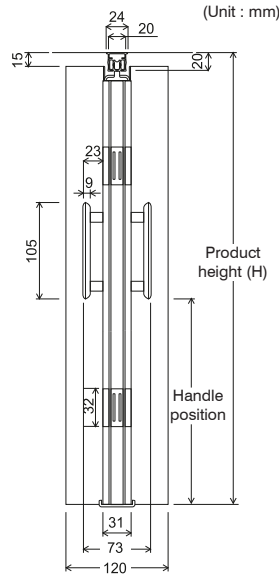

• Handle Position

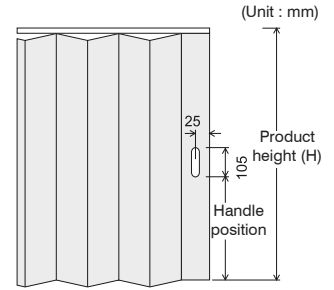

Product height(H)	Handle Position
1,610-1,800	H-700
1,810-1,900	H-860
1,910-2,000	H-960
2,010-2,100	H-1,000
2,110-2,300	H-1,100
2,310-2,400	H-1,200

• Track Cross Section

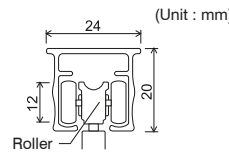

Allowable Size

(Customized product) (Unit : mm)		*For ordering, round down the nearest 10mm both in width and in height. *Maximum allowable size: One-way draw is of 3 m; Split draw is of 6 m.
Product Width (W)	550-5,000	
Product height(H)	610-3,200	
(Standard product) (Unit : mm)		*Only TD-5055 and 5056.
Product Width (W)	550-5,000	
Product height(H)	610-3,200	

Stack-up Guide

(Unit : mm)			
Product Width (W)	Stacked-up Height	Product Width (W)	Stacked-up Height
1,000	245	2,250	410
1,250	265	2,500	435
1,500	295	2,750	485
1,750	335	3,000	530
2,000	360		

Product Weight Guide

Product Width 1,000 mm X Product height 2000 mm : 7.0 Kg.
Product Width 1,500 mm X Product height 2000 mm : 9.5 Kg.
Product Width 2,000 mm X Product height 2000 mm : 12.5 Kg.

Installation Method.

1. Installing of the main unit



Caution

Installing and removing should be done always by two people.
Fabric that tied the door body should not remove until the installing is end.

- ① Remove the track side cover, pass through rollers of the body to the track, set the track on the body, and disconnect the alignment rod slowly with pliers.

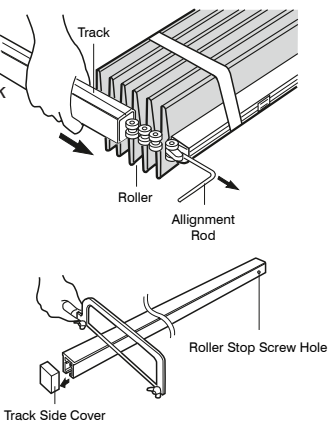

(For cutting the Track)

Remove the track side cover, and cut the track of opposite side of the roller stop screw hole with hacksaw. Clean up metal chips remaining in the track.

- ② Lift up the body, and attach the track with screws (pan o/3.5 X 25). (One person hold the body, and the other person attach the track.) Install the track with screws in order: first in the center of the track, and next both ends.

*Be careful not to scrape the track with a screwdriver so as not to become worse the slipping of rollers.

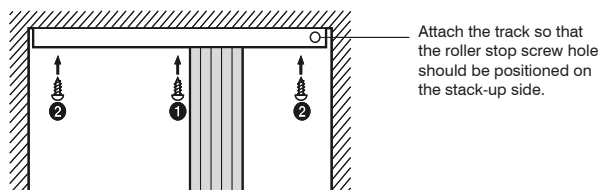

(For the split draw)

- First, attach one track to the body.
- Attach another track, and not to make any gap in the seam of track.
- Attach the Intermediate stop in the connect part.

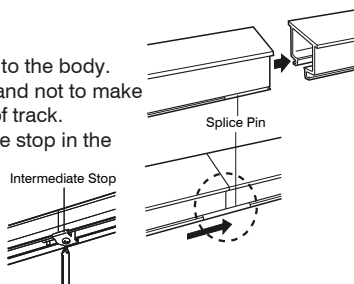

- ③ Attach the Magnet Adsorption Plate with screw (countersunk 3.1 X 16) to fit the magnet position of the body.

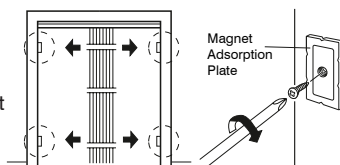

(For fixing one side with the one-way draw)

Fix the Pilot Roller on the fixed side with the Roller Stop Screw (pan ϕ 3.1 X 20).

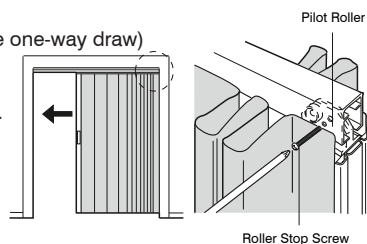

- ④ Remove the fabric that tied the the body.

2. Removing of the main unit



Caution

Because it is dangerous to drop and fall down the main body, another person should always sustain the main body by hand.

- ① Fold up the body, and move to the center.
② Previously remove the screws at both ends, and remove the screw of the center last.

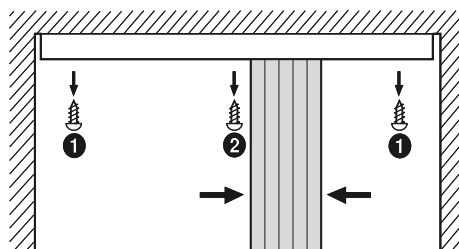

Operation Method

Opening and closing should always be done by done gripping the handle.

How to Take Measurements

*For the product dimensions, specify to round down the nearest 10mm.

(Customized product)

Width: Internal dimensions of a door frame.

Height: subtract approx 20mm from the height of the opening height.

(Standard product)

Choose the size that fits to the mounting location from in the line up.

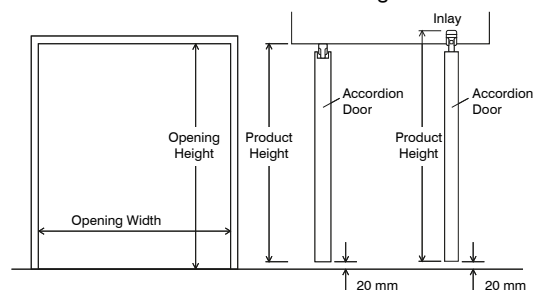

*Product Height: from the track top to the bottom of the product body.

Subtract approx. 20mm from the top of the carpet if you lay the carpet.

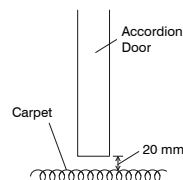

ACCORDION DOOR

Long Handle Type (Antibacterial)

Long Handle type easier to grip than normal handle. The elderly and wheelchair users, as well as healthy people are able to grip the handle in a natural posture. The surface has been applied antibacterial processing and it is clean.



TD-5053
Long Handle: Platinum Gray

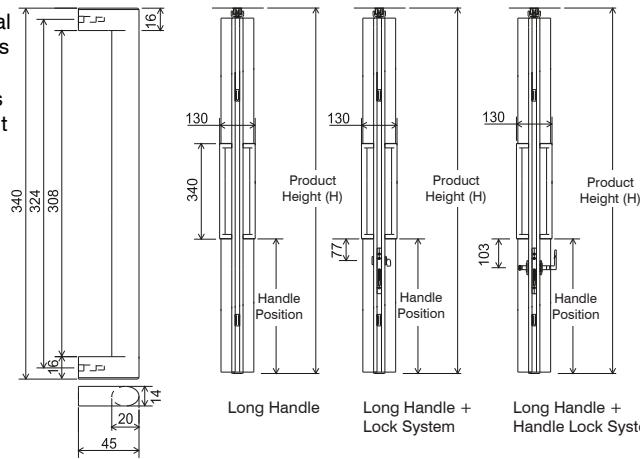

Available Types	
○: allowable x: non-allowable	
CLOZA EXCEL	○
CLOZA LIGHT	x

Price

One-way draw
Standard price + 3,000 Yen (tax excluded)
*One pair for the front and back Fabrics.

Split draw
Standard price + 6,600 Yen (tax excluded)
*Two pair for the front and back Fabrics.

(Unit: mm)

Product Height (H)	Handle Position	Product Height (H)	Handle Position	Product Height (H)	Handle Position
610-1,000	None	2,010-2,100	H - 1,226	2,710-2,800	H - 1,826
1,010-1,200	H - 746	2,110-2,300	H - 1,326	2,810-2,900	H - 1,926
1,210-1,700	H - 826	2,310-2,400	H - 1,426	2,910-3,000	H - 2,026
1,710-1,800	H - 926	2,410-2,500	H - 1,526	3,010-3,100	H - 2,126
1,810-1,900	H - 1,026	2,510-2,600	H - 1,626	3,110,3,200	H - 2,226
1,910-2,000	H - 1,126	2,610-2,700	H - 1,726		

(Unit: mm)

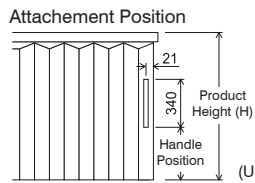

Allowable Attachment Height

Long Handle	Product Height: 1,010 mm or more
Long Handle + Lock System	Product Height: 1,210 mm or more
Long Handle + Handle Lock System	Product Height: 1,210 mm or more

(Unit: mm)

Both Sides Handle Type (Antibacterial)

It is possible to attach the handle on both sides. If you want to open and close from every side of left or right, it is recommended.



Available Types	
○: allowable x: non-allowable	
CLOZA EXCEL	○
CLOZA LIGHT	○

Price

One-way draw
Standard price + 2,600 Yen (tax excluded)
*One pair for the front and back Fabrics.

Split draw
Standard price + 5,200 Yen (tax excluded)
*Two pair for the front and back Fabrics.

Front and Back Different Fabric Type

You can choose different pattern of Fabrics in the frony and back surface. As a partition, it is recommended in the place where is the taste of the room is different.

Caution

In the case of CLOZA EXCEL Handle lock type, please specify the Handle position as well as front and back fabrics.

CLOZA EXCEL

*See-through Fabric (TD-5011-5015) is not available.
*Parts colour is standard colour of surface Fabric. Some colour other than standard colour also can choose.

CLOZA LIGHT

*Parts colour is standard colour of surface Fabric, however back side Handle colour is standard colour of back surface Fabric. Some colour other than standard colour also can choose.

Available Types	
○: allowable x: non-allowable	
CLOZA EXCEL	○
CLOZA LIGHT	○

Price
No additional charge.

Upper Part Fabric for See-through Type

You can choose upper part see-through type on front and back fabric. While maintaining the care of elders and children, also keeping their privacies.

Allowable Size

Product Width (W)	550-5,000mm
Product height(H)	1,300-3,200mm

*For ordering, round down the nearest 10mm both in width and in height.

Allowable Fabric

Upper Part Fabric	TD-5011-5015
Lower Part Fabric	TD-5001-5010, 5016-5066

Part Colour

It becomes the standard colour of the lower part fabric. Some colour other than standard colour also can choose.

Two Types

We have two types of upper see-through height. Please specify which height at the time of your order.



Upper Part Fabric: TD-5013
Lower Part Fabric: TD-5017

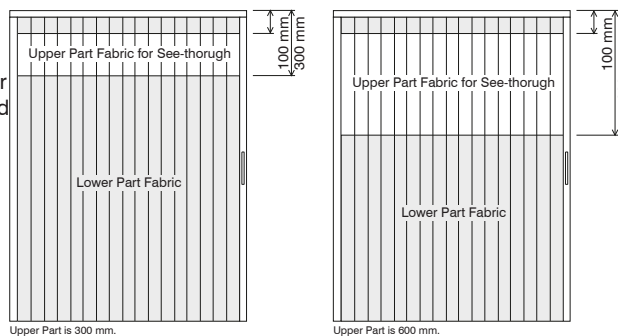

Upper Part is 300 mm.

Upper Part is 600 mm.

Available Types

○: allowable x: non-allowable

CLOZA EXCEL	○
CLOZA LIGHT	x

Price

Standard price of lower part Fabric+ 15,900 Yen (tax excluded)

Inlay Systems Type

By inlaid the Track to the ceiling, hanging roots look neat.

*inlay type requires a groove processing to the ceiling before installing the product.



CLOZA EXCEL

(Unit: mm)

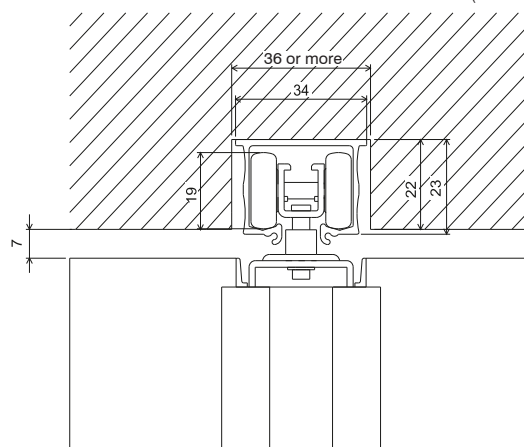

CLOZA LIGHT

(Unit: mm)

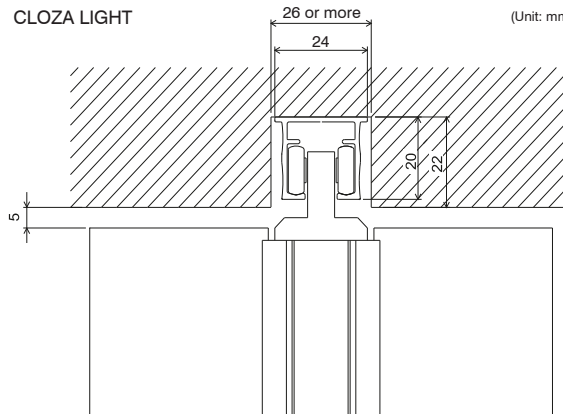

Available Types

○: allowable x: non-allowable

CLOZA EXCEL	○
CLOZA LIGHT	○

Price

No additional charge

ACCORDION DOOR

Lock System

Lock and unlock type by using the key. It is recommended to the location where you want to secure privacy such as your study or workplace.

*In the case of front and back different Fabric type, be sure to specify the Fabric product code of the keyhole side.



Keyhole side



Knob side

Keyhole, knob colour: Silver

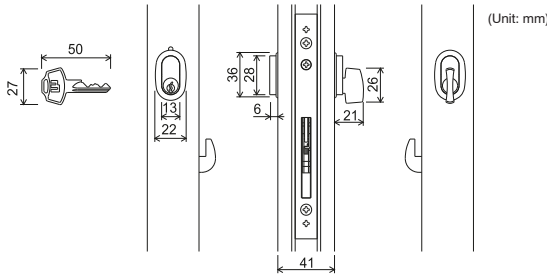

(Unit: mm)

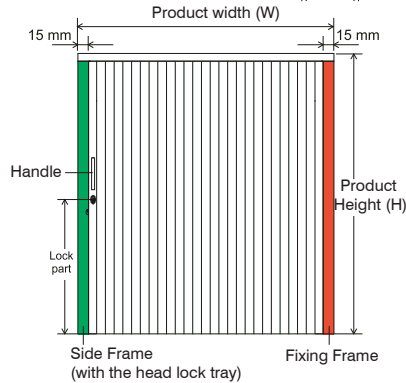

Product Height(H)	Lock Position	Product Height(H)	Lock Position
610-900	H - 375	2,410-2,500	H - 1,355
910-1,200	H - 575	2,510-2,600	H - 1,455
1,210-1,700	H - 655	2,610-2,700	H - 1,555
1,710-1,800	H - 755	2,710-2,800	H - 1,655
1,810-1,900	H - 855	2,810-2,900	H - 1,755
1,910-2,000	H - 955	2,910-3,000	H - 1,855
2,010-2,100	H - 1,055	3,010-3,100	H - 1,955
2,110-2,300	H - 1,155	3,110-3,200	H - 2,055
2,310-2,400	H - 1,255		

(Unit: mm)

Available Types

○:allowable ×:non-allowable

CLOZA EXCEL	
	○
CLOZA LIGHT	
	×

Price

One-way draw

Standard price +24,700 Yen (tax excluded)
(with Side Frame: 1, Fixing Frame: 1, Key: 3)

Split draw

Standard price +25,400 Yen (tax excluded)
(with Fixing Frame: 2, Key: 3)

One-way draw

One-way draw, left lock

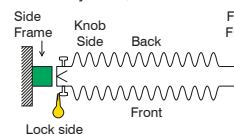

One-way draw, right lock

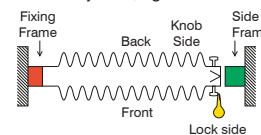

Use one-side Fixing Frame and one-side Side Frame, and attached the lock on the Side Frame side.

Split Draw

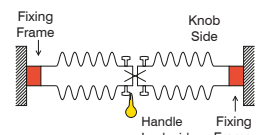

Use Fixing Frame on both sides.

Handle Lock System Type (Antibacterial)

It is possible to attach the Handle on both sides. If you want to open and close from every side of left or right, it is recommended.



Keyhole side

Knob side



Locked

Unlocked

Keyhole, knob colour: Platinum Gray

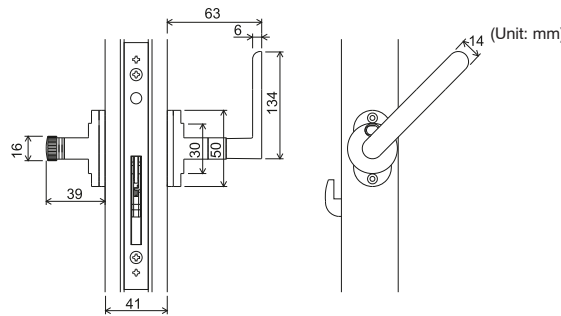

(Unit: mm)

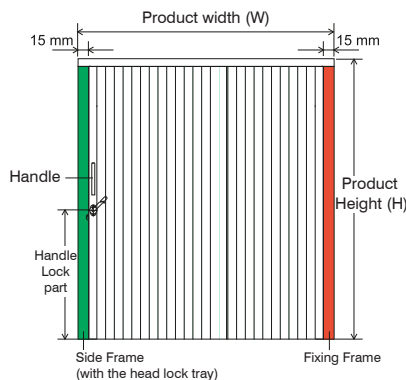

Product Height (H)	Handle Lock Position	Product Height (H)	Handle Lock Position
610-900	H - 400	2,410-2,500	H - 1,380
910-1,200	H - 600	2,510-2,600	H - 1,480
1,210-1,700	H - 680	2,610-2,700	H - 1,580
1,710-1,800	H - 780	2,710-2,800	H - 1,680
1,810-1,900	H - 880	2,810-2,900	H - 1,780
1,910-2,000	H - 980	2,910-3,000	H - 1,880
2,010-2,100	H - 1,080	3,010-3,100	H - 1,980
2,110-2,300	H - 1,180	3,110-3,200	H - 2,080
2,310-2,400	H - 1,280		

(Unit: mm)

Available Types

○:allowable ×:non-allowable

CLOZA EXCEL	
	○
CLOZA LIGHT	
	×

Price

One-way draw

Standard price +45,700 Yen (tax excluded)
(with Side Frame: 1, Fixing Frame: 1)

Split draw

Standard price +46,400 Yen (tax excluded)
(with Fixing Frame: 2)

One-way draw

One-way draw, left handle lock

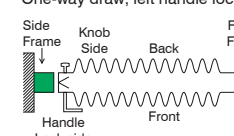

One-way draw, right handle lock

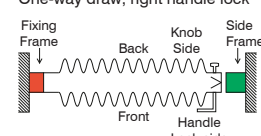

Use one-side Fixing Frame and one-side Side Frame, and attached the handle lock on the Side Frame side.

Split Draw

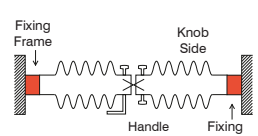

Use Fixing Frame on both sides.

Caution

In the case of front and back different Fabric type, please direct the front and back of the fabrics, and the handle lock position.

Curved Type.

■ Curved Type.

It is used as a partition to the corner in the storage space or dressing room.

Allowable Size

CLOZA EXCEL	Product Width (W)	550-4,500 mm
	Product Height (H)	610-3,200 mm
CLOZA LIGHT	Product Width (W)	600-3,000 mm
	Product Height (H)	1,610-2,400 mm
Curved Type	L-shaped Curve	450 mmR 800 mmR or more
	Overall Curve	800 mmR or more

*For ordering round down the nearest 10 mm both in width and in height.

*Including the Tieback Hook and the Tieback (using the same fabric). 800 mmR or more

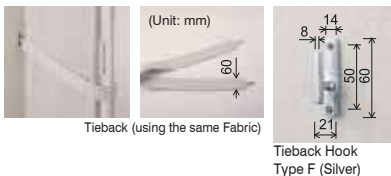

Tieback (using the same Fabric)

Tieback Hook Type F (Silver)

	Owo-way Draw	Split Draw
Tieback (using the same Fabric)	1	2
Tieback Hook Type F	2	4

L-shaped Curve



TD-5053

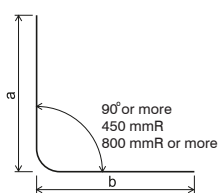

Product width = a + b
*Linear portions of "a" and "b" are 200 mm or more

Overall Curve



TD-5046

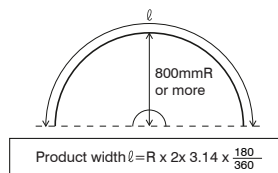

Available Types

○:allowable x:non-allowable

CLOZA EXCEL	○
CLOZA LIGHT	○

Price

CLOZA EXCEL

Standard price multiplied by 1.2 (tax excluded)

CLOZA LIGHT

Standard price multiplied by 1.3 (tax excluded)

*No allowable for standard products.

*Less than 100 yen is rounded.

Cut-out.

Cut-out possible for the part of the product, if there are obstacles around at the top or bottom of the product installation location.

Upper Position Cut-out

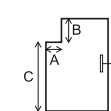

Allowable Size

A	70-450 mm
B	50-500 mm
C	1,200 mm-

Lower Position Cut-out

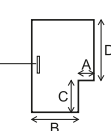

Allowable Size

A	70 mm-
B	400 mm-
C	50 mm-
D	500 mm-

Upper and Lower Position Cut-out

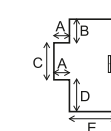

Allowable Size

A	70-450 mm
B	50-500 mm
C	1,200 mm-
D	B-
E	1,000 mm-

*For ordering of the cut-out, round down the nearest 10 mm both in width and in height.

*Cut-out part is the opposite of the handle.

Available Types

○:allowable x:non-allowable

CLOZA EXCEL	○
CLOZA LIGHT	x

Price

Upper cut-out

Standard price + 16,000 Yen (tax excluded)

Lower cut-out

Standard price + 16,000 Yen (tax excluded)

Upper and Lower cut-out

Standard price + 32,000 Yen (tax excluded)

Option Parts.

■ Intermediate Stop

It is used in the case to fix the product in the middle of the Track, or to use as a mark at the center position of split draw.

CLOZA EXCEL

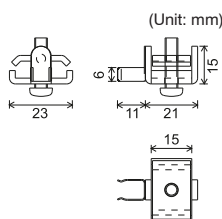

CLOZA LIGHT

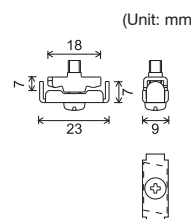

White



Platinum Gray



Dark Bronze



White



Platinum Gray

Available Types

○:allowable x:non-allowable

CLOZA EXCEL	○
CLOZA LIGHT	○

Price

CLOZA EXCEL

1 piece: 180 Yen (tax excluded)

CLOZA LIGHT

1 piece: 120 Yen (tax excluded)

*It takes delivery time if you order it separately.

ACCORDION DOOR

End Cap

It is used when the end of the Track is not a wall, to prevent falling out the product.

CLOZA EXCEL

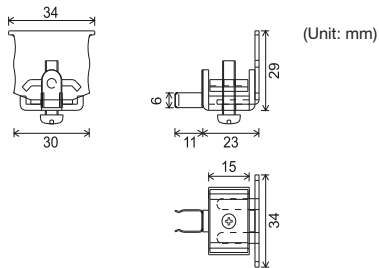

White Platinum Gray Dark Bronze

CLOZA LIGHT

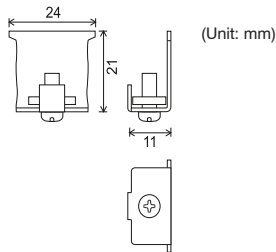

White Platinum Gray

Available Types

○:allowable ×:non-allowable

CLOZA EXCEL	○
CLOZA LIGHT	○

Price

CLOZA EXCEL

1 Piece: 320 Yen
(tax excluded)

CLOZA LIGHT

1 Piece: 180 Yen
(tax excluded)

*It takes delivery time if you order it separately.

Kamoi Bracket (for a Japanese sliding door)

Use to install the product on the lintel part.

CLOZA EXCEL



Product Width (mm)	Track	Number
550-1,200	1	3
1,210-1,650	1	4
1,660-2,400	1	5
2,410-3,300	1	7
3,310-4,000	1	9
4,010-4,500	1 (Optional)	9
	2 (Standard)	10
4,510-4,800	2	10
4,810-5,000	2	14



White Platinum Gray Dark Bronze

CLOZA LIGHT



Product Width (mm)	Number
600-1,000	3
1,010-1,750	4
1,760-2,250	5
2,260-2,750	7
2,760-3,000	9



White Platinum Gray

Available Types

○:allowable ×:non-allowable

CLOZA EXCEL	○
CLOZA LIGHT	○

Price

1 Piece: 180 Yen
(tax excluded)

*It takes delivery time if you order it separately.

Attachment

Track Fixing Screw:
(pan M4 x 5) 1 piece
Bracket Screw:
(pan 3.5 x 30) 2 pieces

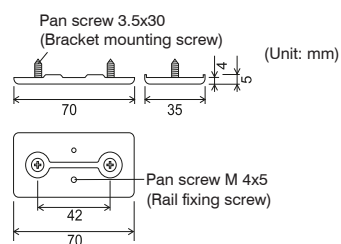

Side Frame.

If the wall has a level difference because of the skirting board or crownmolding, it fills a gap (thickness of skirt board, tec.) between the product and wall.



(Unit: mm)

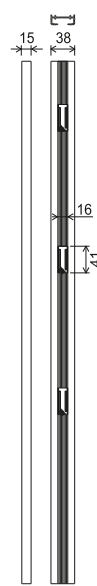

White



Platinum Gray



Dark Bronze

Available Types

○:allowable x :non-allowable

CLOZA EXCEL	○
CLOZA LIGHT	x

Price

1 Piece: 6,000 Yen
(tax excluded)

*It takes delivery time if you order it separately.

Wall Fitting.

Use to fix one side of the product to the wall.

Product Height (mm)	Number
-2,200	2
2,210-	3

Available Types

○:allowable x :non-allowable

CLOZA EXCEL	○
CLOZA LIGHT	○

Price

CLOZA EXCEL

1 Piece: 310 Yen
(tax excluded)

CLOZA LIGHT

1 Piece: 180 Yen
(tax excluded)

*It takes delivery time if you order it separately.

CLOZA EXCEL

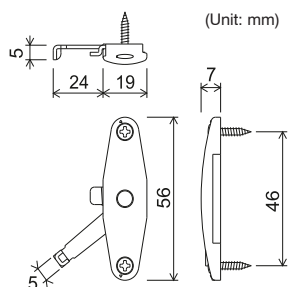

Mounting screws
(pan φ 3 x 16)



Platinum Gray

CLOZA LIGHT

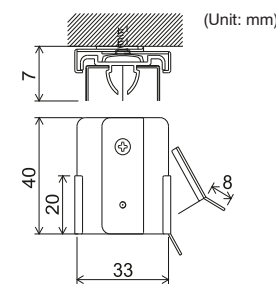

Mounting screws
(countersunk φ 3.1 x 16)



Silver

ACCORDION DOOR

Fixing Frame

It is used if the wall has a level difference because of the skirting board or crown molding, and fixing one side of the product to the wall.



A fixed state

(Unit: mm)

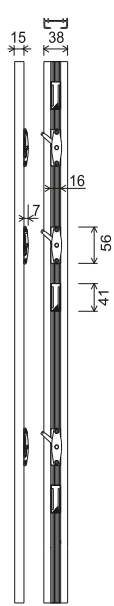

White



Platinum Gray



Dark Bronze

Available Types

○:allowable x:non-allowable

CLOZA EXCEL	○
CLOZA LIGHT	x

Price

1 Piece: 6,700 Yen (tax excluded)

*It takes delivery time if you order it separately.

Adjustable Hanger Rod

Adjustable Hanger Rod

Use to hang the product from the ceiling. two-hanging:

Use to support the track in the middle hanging.

Three-hanging:

If the track end can not be fixed to the wall, attach the Track with three-hanging to prevent rolling the Track.

One place is necessary within a 500 mm interval.

position of both ends: appropriate to locate them in a position 50-100 mm inward from each Track end.

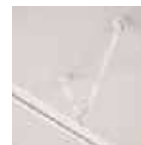
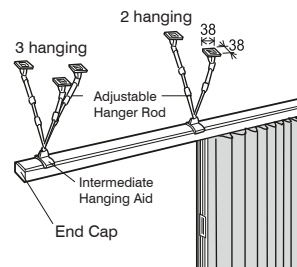

White



Umber

Available Types

○:allowable x:non-allowable

CLOZA EXCEL	○
CLOZA LIGHT	○

Price

Adjustable Hanger Rod B400 (250-400 mm)

1 Piece: 1,110 Yen (tax excluded)

Adjustable Hanger Rod B700 (400-700 mm)

1 Piece: 1,470 Yen (tax excluded)

*It takes delivery time if you order it separately.

Overhead Hanger

On middle portion, it is a connecting part both the Track and adjustable hanger rod.

One place is necessary within a 500 mm interval.

position of both ends: appropriate to locate them in a position 50-100 mm inward from each track end.



CLOZA EXCEL



White

Platinum Gray

Dark Bronze

CLOZA LIGHT



White

Platinum Gray

Available Types

○:allowable x:non-allowable

CLOZA EXCEL	○
CLOZA LIGHT	○

Price

CLOZA EXCEL

1 Piece: 140 Yen (tax excluded)

CLOZA EXCEL

1 Piece: 100 Yen (tax excluded)

*It takes delivery time if you order it separately.

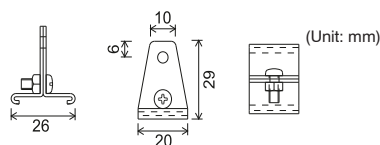
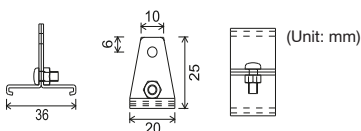

Wall Bracket.

Use to fix the Track on the wall at middle portion.

CLOZA EXCEL

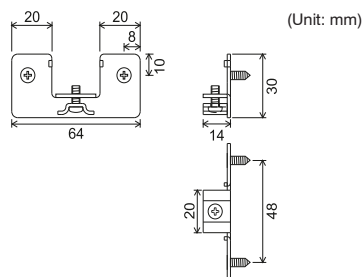

White Platinum Gray Dark Bronze

CLOZA LIGHT

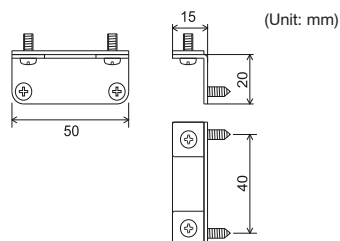

White Platinum Gray

Available Types

○allowable × non-allowable

CLOZA EXCEL	○
CLOZA LIGHT	○

Price

CLOZA EXCEL

1 Piece: 140 Yen
(tax excluded)

CLOZA LIGHT

1 Piece: 140 Yen
(tax excluded)

*It takes delivery time if you order it separately.

Maintenance.

Maintenance Sticker

The purchasing product (custom-made product only) has been attached the maintenance sticker that describes the information about the product. See this maintenance sticker when inquiries and repair of the product.

Production data are described.

● 生産日: **, **, **

● 品名: CLOZA EXCEL

TD-**** 2000×2000

■ 受注No: *****

TOSO

Made in Japan

Product specifications are described.

CLOZA EXCEL	TD-****	2000×	2000
Product name	Color code	Product width	Product height

CLOZA EXCEL

Pasted on the place where the frame cushion is removed

CLOZA LIGHT

Pasted on the place where the frame cover is removed

How to Care

Wipe lightly with a cloth moistened with detergent if the product gets dirty.
Do not use the paint thinner.

ACCORDION DOOR

How to Shorten the Height.

• CLOZA EXCEL

Between 10 mm and 50 mm, available shorten the product height to the nearest 10 mm.

- ① Remove the main unit from the Track, and remove the End Cap at the bottom of the body.
- ② Remove the Frame Cushion, remove Fixing screw, and remove the Frame Cover.
*Since Frame Holder remains to the cut Frame Side, take care not to lose it.
- ③ Peel off the Fabric about 100-200 mm from the Cut Frame.

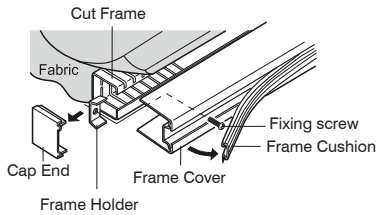

- ④ Cut the Cut Frame in a length you want to shorten with a nipper, and cut out unnecessary part with folding several times. File the cut surface.

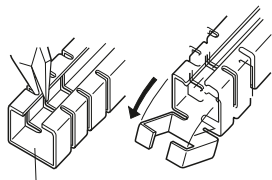

- ⑤ Cut the Fabric leaving the turn-up margin (of 20-50 mm) to fit the Cut Frame. Undo the sewing thread as necessary.

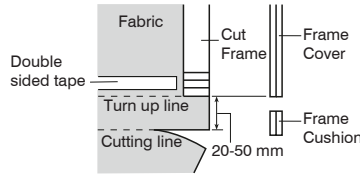

- ⑥ Bond the fabric with double-sided tape along the return line of the fabric.
- ⑦ Cut the Frame Cover and the Fabric Cushion with hacksaw to fit the Cut Frame.
- ⑧ Paste the fabric to the Cut Frame.

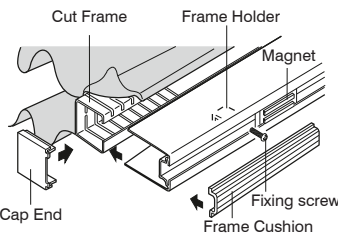

- ⑨ Insert the magnet to the frame cover, and relocate to the original position.
- ⑩ Do a temporarily tacking of the fixing screw and the frame holder to the frame cover.

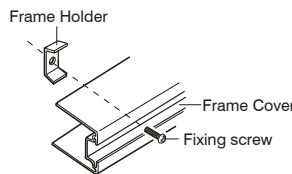

*Tacking of the Fixing screw should be to the extent that Frame Cover and the Frame Holder hit as shown in the figure.

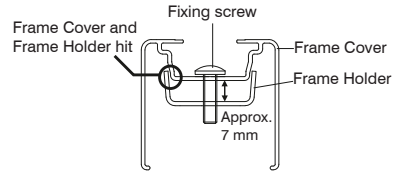

- ⑪ Fit the Frame Cover to the Cut Frame, suit the position of the Handle, push strongly and fix it by tightening the Fixing screw.
*Push the Frame Cover strongly and firmly.

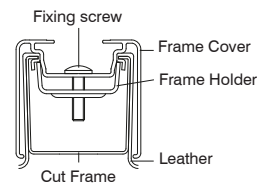

- ⑫ Attach the Frame Cushion and the End Cap.
- ⑬ Attach the main unit to the track.
*If the slack of the Fabric has occurred, adjust the Fabric by pulling the tension tape to the bottom. If the tape is visible from the bottom of fabric, cut the tape.

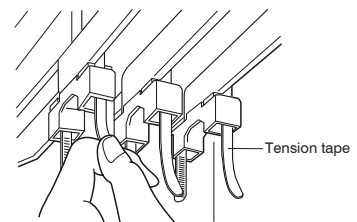

• CLOZA LIGHT

Available shorten the product height to the nearest 10 mm in the following range. (Unit: mm)

Product height (Two digits)	-0	-10	-20	-30	-40	-50	-60	-70	-80	-90
Allowable shortening length	90	00 (60)	10 (70)	20 (80)	30 (90)	40	50	60	70	80

- ① Remove the main unit from the track, and remove the End Cap at the bottom of the body.
- ② Remove the End Cap and the Frame Cover at the bottom of the body.
- ③ Peel off Fabric about 100-200 mm from Cut Frame.

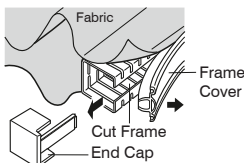

- ④ Cut the Cut Frame in a length you want to shorten with nipper, and cut out unnecessary part with folding several times. File the cut surface.

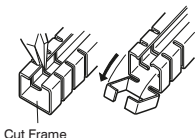

- ⑤ Cut the Fabric leaving the turn-up margin (of 20-50 mm) to fit the Cut Frame. Undo the sewing thread as necessary.

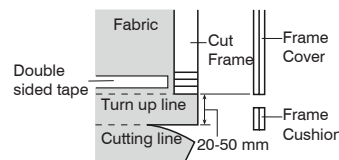

- ⑥ Bond the Fabric with double-sided tape along the return line of Fabric.
- ⑦ Cut the Frame Cover and the Frame Cushion with hacksaw to fit the Cut Frame.
- ⑧ Paste the Fabric to the Cut Frame.
- ⑨ Push strongly the Frame Cover to the Cut Frame, and attach the End Cap.

- ⑩ Attach the main unit to the Track.

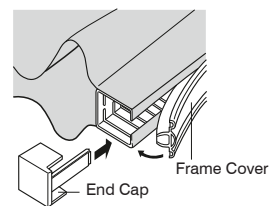

*If the slack of the Fabric has occurred, adjust the Fabric by pulling the tension tape to the bottom. If the tape is visible from the bottom of fabric, cut the tape.

